

SECTION C-C

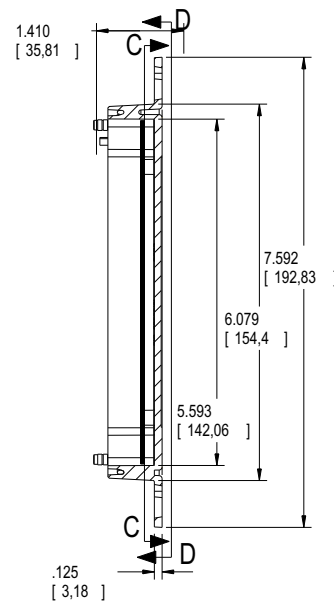

SECTION B-B

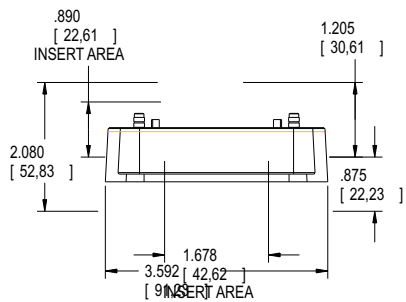
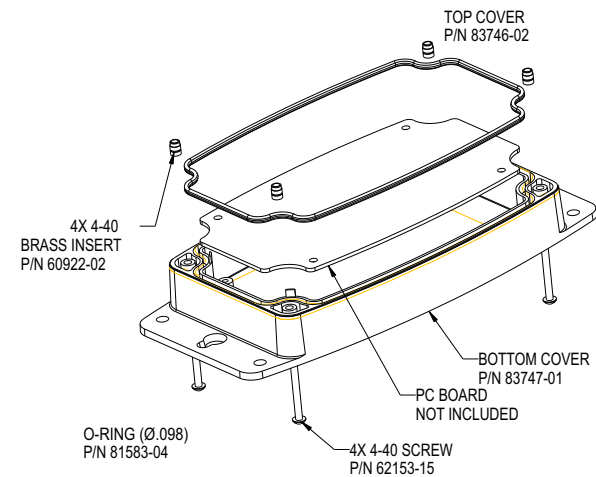

SECTION A-A

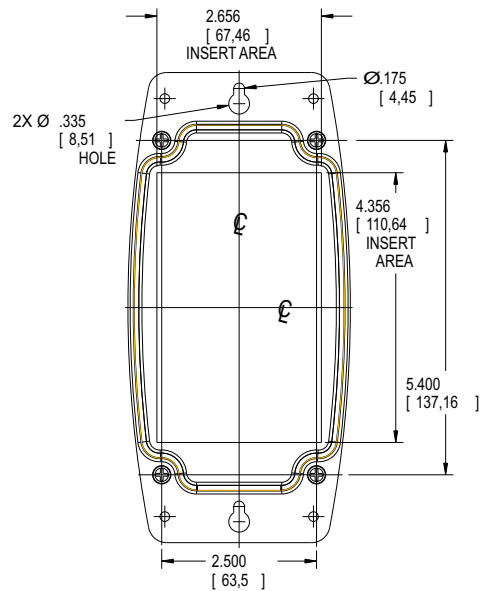

SECTION D-D

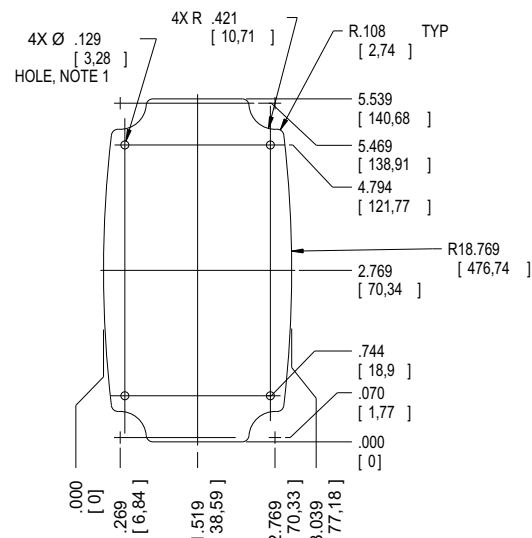

MAX PCB SIZE: .063 TK

NOTES:

1. USE #4 TYPE "B" THREAD FORMING SCREWS X .25 [6,3] OR .31 [7,9] LONG TO MOUNT CIRCUIT CARD ASSEMBLY.

<p>Bezeichnung: Industriegehäuse</p> <p>Artikel-Nummer: GHozKSo49/050 - Boden</p>	<p>Maße in mm</p>