

NOTES:
 1. USE #4 TYPE "B" THREAD FORMING SCREWS X .25 [6.3] OR .31 [7.9] LONG TO MOUNT CIRCUIT CARD ASSEMBLY.

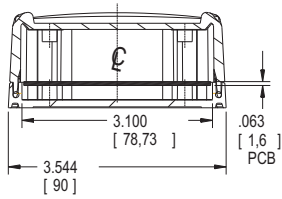

MAX PCB SIZE, .063 THICK
 BOTTOM COVER, CALL FOR TOP COVER PCB SIZE INFO

Bezeichnung: Industriegehäuse Artikel-Nummer: GH02KS049/010	Maße in mm